

Head Office:
Dixon Kelley Estate Agents
1 Penn Court
Station Road, West Moors
Dorset. BH22 0JJ

Dorset Park Homes

DRAFT

www.dorsetparkhomes.com

Telephone: 01202 877511

Plot 27 Stour Park, New Road, Northbourne, Bournemouth, Dorset. BH10 7DE

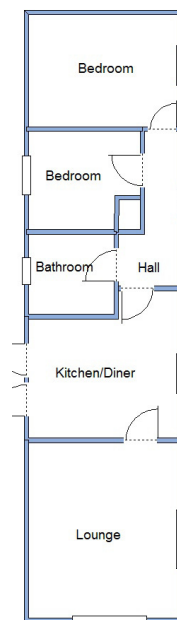

Basic drawing, subject to change.
Not to scale.

BRAND NEW Omar Middleton 2-Bedroom Park Home approx 46' x 12'

Accommodation & approximate room dimensions:

- **Hall**
- **Modern Kitchen/Diner: approx 11'5" x 11'4" max.** Fantastic range of wall & base units. Integrated washing machine, fridge/freezer, electric oven, gas hob & extractor hood (untested). Cupboard housing Combination Gas Fired Boiler (untested). Storage cupboard. PVCu double doors to garden.
- **Lounge: approx 13'3" x 11'5".** Feature fireplace with electric fire fitted (untested). 2 Bay Windows.
- **Bedroom 1: approx 11'5" plus x 10'9" max** including fitted range of bedroom furniture. Bay Window.
- **Bedroom 2: approx 8'7" x 7'6".**
- **Bathroom**
- **Gas Central Heating & PVCu Double Glazing**
- **Block Paved Driveway & GARAGE**
- **Age Restriction 60+**
- **No Pets Allowed**

Luxury Fixtures & Fittings
High Quality Finish Throughout
Fully Furnished
Driveway & GARAGE
Popular Residential Site
Preliminary details subject to change

NEW PARK HOME Sited Feb 2016

Price £149,950

Pitch Fee approx £150 per calendar month

VIEWING STRICTLY BY APPOINTMENT WITH THE VENDOR'S AGENT Dorset Park Homes 01202 877511

IMPORTANT NOTE: These particulars are believed to be correct but their accuracy is not guaranteed. They do not form part of any contract. Nothing in these particulars shall be deemed to be a statement that the property is in good structural condition or otherwise, nor that any of the services, appliances, equipment or facilities are in good working order or have been tested. Purchasers should satisfy themselves on such matters prior to purchase. Ref.W03304

The recommended specialist in Park Home sales
Proprietor: Simon Dixon



Zoopa.co.uk

